

Visiting times and Associated Attendance Times

Lateral flow test time slot	Planned time of visit
9.15	10.am
9.35	10.20am
9.55	10.40am
10.15	11am
10.35	11.20am
11:10	11.55
1.pm	1.45pm
1.20	2.05pm
1.40	2.25pm
2	2.45pm
2.20	3.05pm
2.40 – 3.10	3.25 pm

Please attend for your LFT promptly as these appointment times have been carefully arranged to maximise visiting capacity whilst trying to ensure minimal contact between visitors during this process.

When you arrive for your test please follow the signs and park by the Physiotherapy Department and then proceed to the test lobby. Please do not enter the lobby if it is occupied by the previous visitor awaiting a test. **Please wear your own mask at all times**, when not performing the swab.

- You will need to know your personal details eg NHS number, date of birth, email address (if you have one), and a **mobile** telephone number or one of a trusted friend or relative. You will receive confirmation of your test registration via text message
- You will also need to know Holbeach Hospitals UON (Unique Organisation Number) which is 10145811.
- You will need to sign a consent form prior to your test. If you do not consent to the test and the sharing of the result you will not be permitted entry to the main Home. The consent form will be retained by Holbeach Hospital and be treated in line with our record keeping policy.

Please see the guidance below for advice about the actual Lateral Flow Testing procedure

There are three bar code stickers, one will be attached to the test device, one will be stuck on our records and you will be given the third to enable you to identify you to the LFT test.



- When you are given the swab, you will need to open the opposite end to the padded tip you will be swabbing your throat and nose with.

- It is intended that you perform the swab yourself, but assistance can be given if required. The swab needs to be inserted and rotated for 10 seconds as shown in the diagram below. If you have excess nasal mucus please blow your nose and dispose of the tissue into the waste bin provided prior to the test.

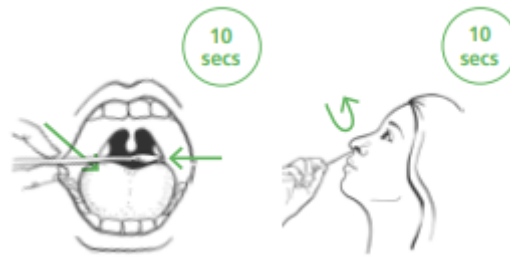

- Once this has been completed please hold the swab in the centre of the wand and hand it to the member of staff performing the test and replace your mask. The results will be ready between 20 – 30 minutes. The member of staff will inform you of the result.

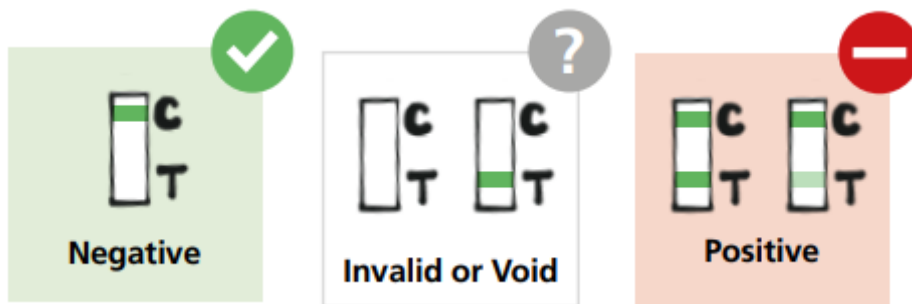

- If you receive a negative test you will be able to proceed with your visit.
- An invalid or void test means that you will need to perform the test again before your visit can proceed.
- A positive result will mean that you will need to perform a different PCR test before you leave the premises. You will have to self-isolate for ten full days and anybody accompanying or you have had recent contact with will also have to isolate for 10 full days. The isolation period will end at midnight on the 10th day meaning on day 11 you can resume your usual contacts within the current Government guidance.

You will need to register the test yourself on your own smart phone or tablet but if do not have either of these we can assist with this.

The form can be found by entering 'Report a Covid 19 self-test result' in your search engine box and selecting

www.gov.uk/report-covid19-result. You will then need to follow the instructions on our screen.

Details needed for the online registration form:

- Full name
- Date of birth
- Gender
- Ethnic group
- Home address
- Contact details, including mobile number and e-mail address
- The barcode number of your test kit
- Date and time of their test
- Test result

GOV.UK Report your COVID-19 test result

Use this service to:

- report your result to the NHS after using kit (also called a lateral flow test kit)
- find out what your result means and get support

Report the result:

- every time you use a self-test kit
- as soon as possible after you get the result

You can't report a result after more than 21 days.

[Start now >](#)

Check answers and report result

Why test later? [Close](#)

Which describes you? [Close](#)

Case number number: 480123456 [Close](#)

Country: England [Close](#)

Test date: 30 October 2020 [Close](#)

Test kit ID number: 12345678 [Close](#)

Name: John Doe [Close](#)

Date of birth: 11/11/2022 [Close](#)

Gender: Female [Close](#)

Ethnic group: White British ethnic group [Close](#)

Ethnic background: Refer not to sex [Close](#)

Address: 123 ABC Road, 1001111 [Close](#)

Email: I do not have an email address [Close](#)

Mobile: 123456789 [Close](#)

Result: Negative [Close](#)

[Report result](#)

- Once the test and result has been registered then proceed to the home for your visit. Please enter via the main entrance and put on your PPE following the displayed instruction. Please sign the visitor's book.



1

Perform hand hygiene using soap and water or alcohol hand gel.



2

Put on a plastic apron and tie it at the waist.



3

Put on a surgical face mask, positioning upper straps on the crown of your head, lower strap at nape of neck. With both hands, mould the metal strap over the bridge of your nose.



4

Put on plastic gloves.

- Once your PPE is in place please proceed directly to your loved one's room. The family room remains closed but there is a designated visitor lavatory to use.
- Please enjoy your visit!!

Once your visit is complete please return to the main entrance to remove your PPE using the method shown below and sign out in the visitors book.

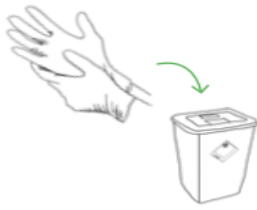

1

Remove gloves; grasp the outside of the cuff of the first glove and peel off, holding the glove in the gloved hand, insert the finger underneath and peel off second glove.

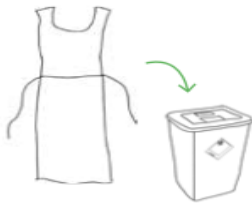

2

Snap or unfasten apron ties at the neck and let the apron fold down on itself. Break ties at waist and fold apron in on itself – do not touch the outside – this will be contaminated. Discard apron.

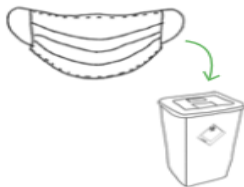

3

Remove surgical mask carefully, and put into clinical waste.



4

Perform hand hygiene using soap and water or alcohol hand gel or rub.

Staff and Residents alike are relying on you to follow the procedures described to reduce the risk of transferring the Covid 19 virus with in the Home. Thank you for your anticipated co-operation.